

Multiple head type punch retainers Portapunzon multiple

Hole locations from datum	
Dowel holes	± 0.01
Screw holes	± 0.13
Component holes	± 0.01

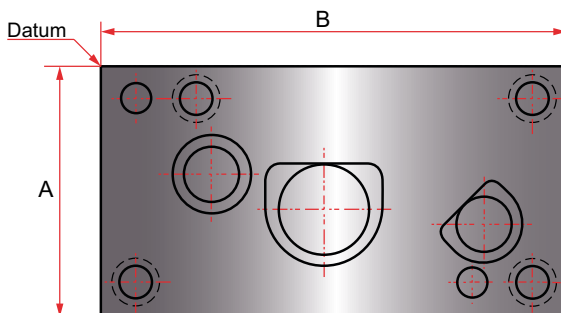

Note: Looking at retainer from punch head side.

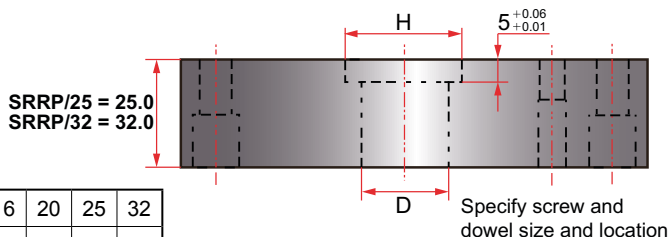

SRRP/25 = 25.0
SRRP/32 = 32.0

D	4	5	6	8	10	13	16	20	25	32
H	8	9	10	12	14	17	20	24	29	36

Type	A	B											
		60	70	80	90	100	125	150	175	200	225	250	300
SRRP/	50	5060	5070	5080	5090	50100	50125	50150	50175	50200	50225	50250	50300
	60	6060	6070	6080	6090	60100	60125	60150	60175	60200	60225	60250	60300
	70		7070	7080	7090	70100	70125	70150	70175	70200	70225	70250	70300
	80			8080	8090	80100	80125	80150	80175	80200	80225	80250	80300
	100					100100	100125	100150	100175	100200	100225	100250	100300
	125						125125	125150	125175	125200	125225	125250	125300
	150							150150	150175	150200	150225	150250	150300
	200								200175	200200	200225	200250	200300

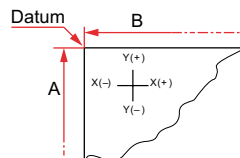
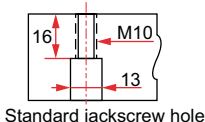
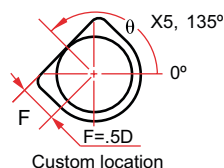
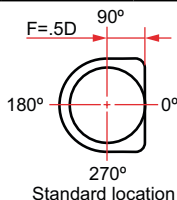

Flat tolerances	
F	RADIAL
+0,025	0,03
-0	25,0

Material	Type	Hardness
1.2312	X0	26-32 HRC
1.2379	X1	47-52 HRC

How to order: Type/_ A/B-Mat. Example: SRRP/25-70200-X0
Forma de pedido: Type/_ A/B- Mat. Ejemplo: SRRP/25-70200-X0