

Ejector Punches ISO 8020  
Punzón expulsor ISO 8020

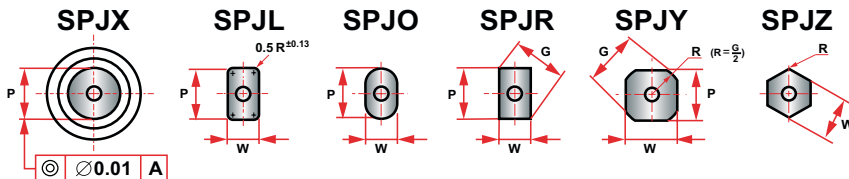
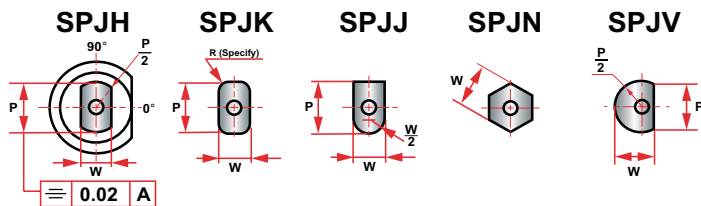
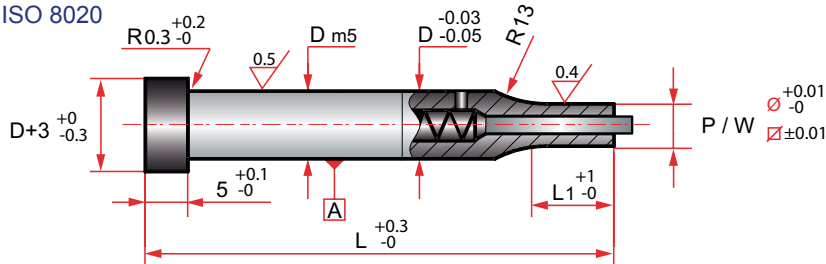

Check "P/W" dimensions to be sure the diagonal "G" does not exceed the max. shown.  
 $G = \sqrt{P^2 + W^2}$

Shank D	Point length L1		Type & D SPPX	Range P	Type & D SPP_	Min. W	Max. P/G	L													
	Std.	Alt.						40	50	56	60	63	70	71	80	90	100				
05	13	19	SPJX 05	1,60 - 4,95	SPJ_05	1,60 - 4,95		*	*	*	*	*	*	*	*	*	*	*	*	*	*
06	13	19	SPJX 06	2,40 - 5,95	SPJ_06	2,40 - 5,95		*	*	*	*	*	*	*	*	*	*	*	*	*	*
08	19	25	SPJX 08	3,20 - 7,95	SPJ_08	3,20 - 7,95			*	*	*	*	*	*	*	*	*	*	*	*	*
10	19	25	SPJX 10	4,50 - 9,95	SPJ_10	4,50 - 9,95			*	*	*	*	*	*	*	*	*	*	*	*	*
13	19	25	SPJX 13	6,00 - 12,95	SPJ_13	6,00 - 12,95			*	*	*	*	*	*	*	*	*	*	*	*	*
16	19	25	SPJX 16	8,00 - 15,95	SPJ_16	7,20 - 15,95			*	*	*	*	*	*	*	*	*	*	*	*	*
20	19	25	SPJX 20	10,00-19,95	SPJ_20	8,00-19,95			*	*	*	*	*	*	*	*	*	*	*	*	*
25	19	25	SPJX 25	12,00- 24,95	SPJ_25	9,00- 24,95			*	*	*	*	*	*	*	*	*	*	*	*	*
32	25	30	SPJX 32	16,00-31,95	SPJ_32	10,00-31,95							*	*	*	*	*	*	*	*	*

Material	Hardness	
	Body	Head
HWS (12% Cr)	62 ± 2 HRC	50 ± 5 HRC
HSS	64 ± 2 HRC	50 ± 5 HRC

How to order : SPJ\_Type & D+L1+L-Mat.+P or W-P/G      SPJR 16 25 80 P8.5 W8.0 x2  
 Forma de pedido: SPJ\_Type & D+L1+L-MAT.+P ó W-P/G      BRSP HSS SPJR 16 25 80 P8.5 W8.0 x2