

BR9861D

Tipo D

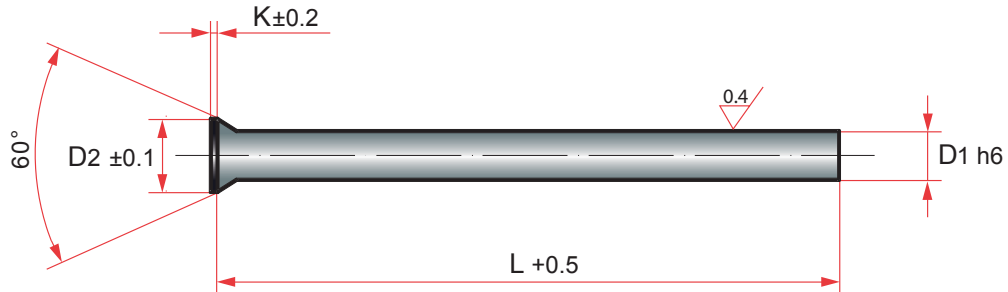

Punch DIN 9861D
Punzón cabeza cónica DIN 9861D



Material	Hardness	
	Body	Head
HWS (12% Cr)	62 ± 2 HRC	50 ± 5 HRC
HSS	64 ± 2 HRC	50 ± 5 HRC

D1	D2	K	L			
			71	80	100	130
0,50	0,9	0,2	*			
0,55	1,0		*			
0,60	1,1		*			
0,65	1,2		*			
0,7 - 0,75	1,3		*			
0,8 - 0,85	1,4	0,4	*			
0,9 - 0,95	1,6		*			
1,0 - 1,1	1,8	0,5	*	*	*	
1,20 - 1,3	2,0		*	*	*	
1,40 - 1,5	2,2		*	*	*	
1,60 - 1,7	2,5		*	*	*	
1,75 - 1,9	2,8		*	*	*	
2,0	3,0		*	*	*	
2,10 - 2,2	3,2		*	*	*	
2,25 - 2,5	3,5		*	*	*	
2,60 - 2,90	4,0		*	*	*	

How to order: DIN9861D/D1xL-Mat .
Forma de pedido: BR9861D/D1xL-Mat.

BR9861D

Tipo D



Punch DIN 9861D
Punzón cabeza cónica DIN 9861D

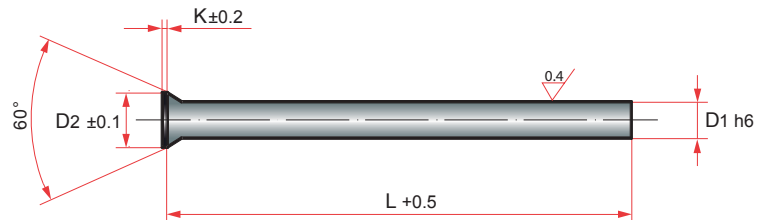

D1	D2	K	L			
			71	80	100	130
3,0 - 3,40	4,5	0,5	*	*	*	*
3,5 - 3,90	5,0		*	*	*	*
4,0 - 4,40	5,5		*	*	*	*
4,5 - 4,90	6,0		*	*	*	*
5,0 - 5,40	6,5		*	*	*	*
5,5 - 5,90	7,0		*	*	*	*
6,0 - 6,4	8,0		*	*	*	*
6,5 - 7,4	9,0	1,0	*	*	*	*
7,5 - 8,4	10,0		*	*	*	*
8,5 - 9,4	11,0		*	*	*	*
9,5 - 10,0	12,0		*	*	*	*
10,5 - 11,0	13,0		*	*	*	*
11,5 - 12,0	14,0		*	*	*	*
12,5 - 13,0	15,0		*	*	*	*
13,5 - 14,0	16,0	1,5	*	*	*	*
14,5 - 15,0	17,0		*	*	*	*
15,5 - 16,0	18,0		*	*	*	*
16,5 - 17,0	19,0		*	*	*	*
17,5 - 18,0	20,0		*	*	*	*
18,5 - 19,0	21,0		*	*	*	*
19,5 - 20,0	22,0		*	*	*	*
21	23,0		*	*	*	*

How to order: DIN9861D/D1xL-Mat .
Forma de pedido: BR9861D/D1xL-Mat.

BR9861D

Tipo D



Punch DIN 9861D
Punzón cabeza cónica DIN 9861D

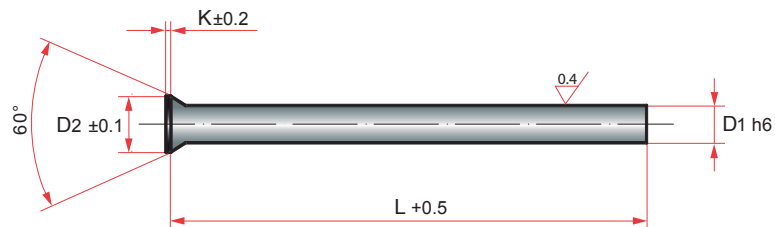

D1	D2	K	L			
			71	80	100	130
22	24,0	1,5	*	*	*	
23	25,0		*	*	*	
24	26,0		*	*	*	
25	27,0		*	*	*	
26	28,0		*			
27	29,0		*			
28	30,0		*			
29	31,0		*			
30	32,0		*			

How to order: DIN9861D/D1xL-Mat .
Forma de pedido: BR9861D/D1xL-Mat.